

c.LOGiC® AV-Interface

C1-PHAETON

**For VW Phaeton, Bentley Continental Group
with ZAB Navigation**

Contents

1. Prior to installation

- 1.1. Delivery contents
- 1.2. Checking the compatibility of vehicle and accessories

2. Installation

- 2.1. Place of installation
- 2.2. Activation of the interface

3. Device control

- 3.1. Device assignment
- 3.2. Compatible device list
- 3.3. Selection of the devices to be controlled
- 3.4. Key configuration
- 3.5. Pictures settings for the Interface

4. Specifications

5. Technical support

Information

Changes of the vehicle software can cause malfunctions of the interface. We offer free software-updates for interfaces for one year after purchase. To receive a free update, the interface must be sent in at own cost. Labor cost for and other expenses involved with the software-updates will not be refunded.

Product features

- Connection of a external AV-input
- Controlable with the original keys of the navigation

1. Prior to installation

Read the manual prior to installation.

Technical knowledge is necessary for installation. The place of installation must be free of moisture and away from heat sources.

1.1. Delivery contents

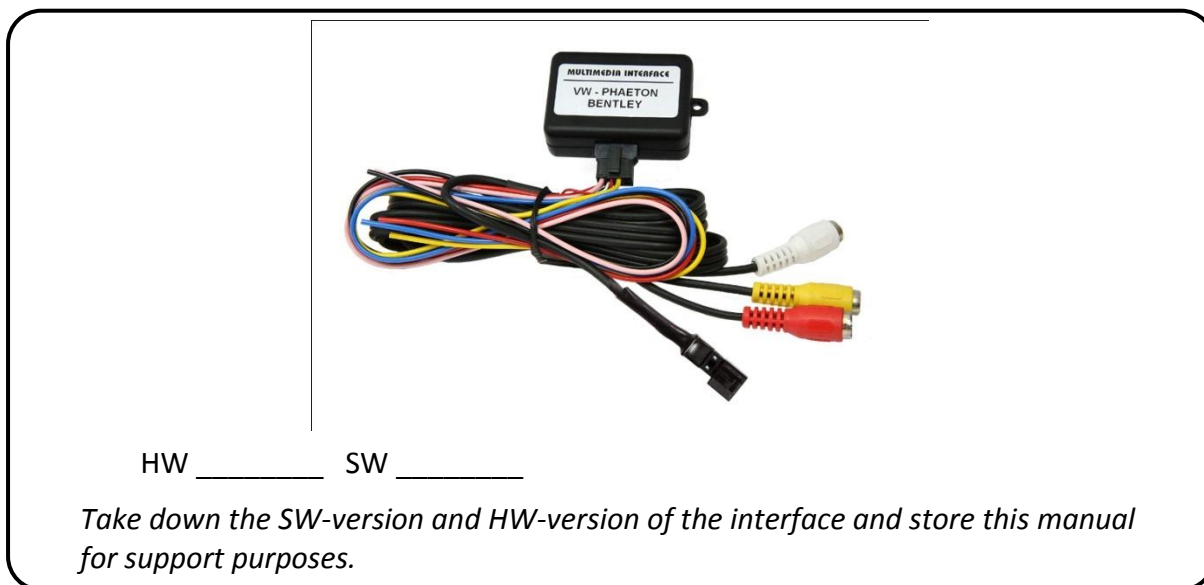

1.2. Checking the compatibility of vehicle and accessories

Requirements	
Vehicle	VW Phaeton, Bentley Continental Group
Navigation	ZAB

2. Installation

Switch off ignition and disconnect the vehicle's battery! The interface needs a permanent 12V source. If power source is not taken directly from the battery, the connection has to be checked for being start-up proven and permanent.

2.1. Place of installation

Carefully remove the decorative covers of the navigation system. Loosen the 5 TORX screws as marked in the picture on the right and extract the device from the center console.



Disconnect the 32pin connector from the navigation system.

Wire Colors/Plugs:	Connection/Assignment:
● Black:	Ground
● Black:	Ground
● Pink:	Y - Signal
● Green:	C - Signal
● Red:	AUDIO Signal Output (right)
● Black:	AUDIO Ground Output (right)
● Yellow:	AUDIO Signal Output (left)
● Black:	AUDIO Ground Output (left)

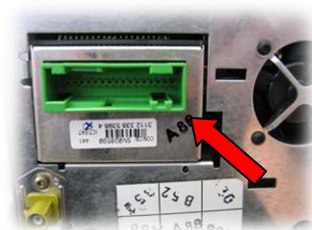

Connection assignment for the 32pin connector: Connect the pink wire of the "Audio/Video" cable kit to Pin 23 and the green wire to Pin 24.

Connect the red wire (Audio Signal right) to Pin 10 and the black wire (Audio Ground right) to Pin 26 (both wires are paired together).

Connect the yellow wire (Audio Signal left) to Pin 11 and the black wire (Audio Ground left) to Pin 27 (both wires are paired together).

Connect the two black wires to Pin 8 and Pin 25.

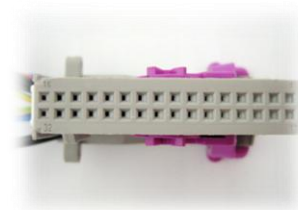

Wire Colors/Plugs:	Connection/Assignment:
● Red:	+12V DC (Permanent Plus)
● Black:	Ground
● Yellow:	CAN-HI
● Blue:	CAN-LOW
● White/Black:	Output +12V (100mA)
3,5mm Mini Jack Socket:	Controls

Connect the yellow wire (CAN-HI) of the interface cable kit to Pin 15 and the blue wire (CAN LOW) to Pin 31.

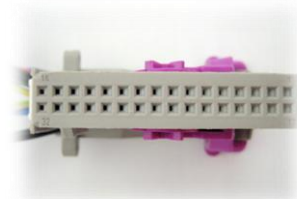

Connect the black wire of the interface cable kit to ground (Power Plug Pin8) and the red wire to 12V permanent plus (Power Plug Pin7).



The 3,5mm mini jack socket of the cable kit is used to connect the corresponding control cable (e.g. "STA-AL25" for DVD Alpine devices) for device controls.

The optionally available Y-Adapter "CABLE-415" (sold separately) allows to connect the IR-receiver of the video source parallel to the interface.



(Please refer to pages 9 and 10 for details regarding control cables.)

STA-xxxx cable kit

Use a Video / Audio cinch cable (sold separately) to connect the video source to the three cinch sockets of the interface.

Re-attach the navigation system to the center console.

2.2. Activation of the interface:

In order to activate controls for the connected devices the system needs to be switched to TV mode by pushing the "AUDIO/TV" button followed by the "TV" button.



3. Device control

3.1. Device Assignment:

Device assignment occurs in the video text level.

Pushing the Softkey button "Videotext" activates the video text level.

The central knob is used to enter the three-digit device RC Code (e.g. **first** device > „101“, **second** device > „203“). Push the central knob to save the selected RC code. Exit the level after RC code input by using the Softkey "Back".



3.2. Compatible device list

IR-control channel	Compatible devices	IR-control-cable
RC-01	DVD-Player maXXLine DVD500U, DVDMP412U, DVDMP20(U)	STA-USB
	DVD-Player Ampire DVX100, Digitaldynamic DVP-1000, 900HD	
	DVD-Player DVD500U	STA-UNI
RC-02	DVB-T Tuner maXXLine DVBD50, Dietz 1491(V)	STA-D2007
RC-03	DVB-T Tuner Ampire DVB-T 100	n/v
RC-07	DVB-T Tuner DVBT-CKO, maXXLine DVBD60, DVBD40	STA-NL
RC-10	DVD-Player Alpine RUE-4201	STA-AL25
RC-11	DVD-Player Alpine RUE-4158	STA-SV4
	DVBT-Tuner Alpine TUE-T150V	STA-AL25
RC-13	iPod Vlink maXXLine	STA-USB
RC-15	Vehicle-HUB Alpine VPA-B222R, Alpine RUE-4167 Audio	STA-AL25
RC-16	Vehicle-HUB Alpine VPA-B222R, Alpine RUE-4167 DVD	STA-AL25
RC-17	DVD-Wechsler 6-fach Necvox DVA-3206	n/v
RC-18	Analog TV-Tuner Alpine TUE-T112P	STA-AL25
RC-20	DVD-Player Boa 85700	STA-USB
RC-24	DVD-Wechsler 6-fach maXXLine DVC62, Ampire DVC62	STA-UNI
RC-27	DVD-Player Nesa DVD-2007, DVD-1002, VST VDV-101	STA-USB
RC-30	DVB-T Tuner Ampire DVBT200	STA-NL
RC-32	iPod Alpine KCE-425I	STA-UNI
RC-34	DVB-T Tuner Clarion DTX509E NEU	STA-SV43
RC-41	DVB-T Tuner NavLinkz DVBT330, ACV, maXXline DVBD80	STA-NL
RC-43	DVB-T Tuner Ampire DVBT50	STA-NL



3.3. Selection of the devices to be controlled:

Use the navigation system's buttons to control the video source(s).
The Softkey button "Sender verfolgen" switches between devices:
ON = Device 1 , OFF = Device 2 .
Please refer to page 10 for detailed button assignments.



In order to use the controls, level A 1-6 needs to be activated
at Softkey "A 1-6 / M 1-6".



Video device menus are controlled via the "Settings"
level. Use the central knob to navigate "left" / "right"
and push station button "5" to confirm a selection.



3.4. Key configuration



Button Assignment Part 1

Phaeton Navigation										
Model	1	2	3	4	5	6	7	8	9	10
DVD PLAYER	ON/OFF	MENU PBC	MENU	TITLE	PLAY	STOP	TRACK -	TRACK +	↑	↓
DVB-T TUNER	ON/OFF	EPG	SETUP	INFO	ENTER	EXIT	CH -	CH +	↑	↓
I-POD® CONTROL	ON/OFF	SHUFFLE	BULB	REPEAT	ENTER	PLAY	TRACK -	TRACK +	↑	↓
ANALOG TUNER	ON/OFF	FM	ADJUST	DISPLAY	SCAN	MUTE	CH -	CH +	VOL +	VOL -

Button Assignment Part 2

Phaeton Navigation					
Model	9*	10*	Softkey Button "Sender verfolgen"	Softkey Button "TV / AV"	Softkey Button "Autostore"
DVD PLAYER	→	←	SWITCH DEVICE	AV	ZOOM / DISC
DVB-T TUNER	→	←	SWITCH DEVICE	AV	SCAN
I-POD® CONTROL	→	←	SWITCH DEVICE	EJECT	-
ANALOG TUNER	CH +	CH -	SWITCH DEVICE	SCAN	SCAN

* Function of central knob in the "Settings" level (lower right knob has no function assigned to it) .

4. Technical data

Working voltage range:	10.5 - 14.8 V
Stand-by current consumption:	> 1 MA
Operating current consumption:	35 MA
Power input	6.8 W
Max. current consumption:	approx. 200 MA
Working temperature:	-30°C to +80°C
Weight:	85 g
Dimensions W x H x D:	85 x 20 x 42 mm

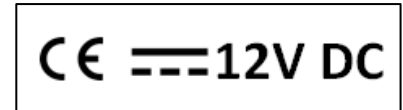

5. Technical Support

Caraudio-Systems Vertriebs GmbH
manufacturer/distribution
Rheinhorststr. 22
D-67071 Ludwigshafen am Rhein

NavLinkz GmbH
corporate sales/tech support
Eurotec-Ring 45
D-47445 Moers

phone +49 180 3 907050
email support@caraudio-systems.de