

TV-Free Video-in-motion Interface

TF-MFD3

for Volkswagen MFD3/RNS510, Skoda Columbus and Seat Trinax navigation systems

Legal Information

By law, watching moving pictures while driving is prohibited, the driver must not be distracted. We do not accept any liability for material damage or personal injury resulting, directly or indirectly, from installation or operation of this product. This product should only be used while standing or to display fixed menus or rear-view-camera video when the vehicle is moving, for example the MP3 menu for DVD upgrades.

Changes/updates of the vehicle's software can cause malfunctions of the interface. We offer free software-updates for our interfaces for one year after purchase. To receive a free update, the interface must be sent in at own cost. Labor cost for and other expenses involved with the software-updates will not be refunded.

Contents

1. Prior to installation

- 1.1. Delivery contents
- 1.2. Check compatibility of vehicle and accessories
- 1.3. Setting the Dip-switches of the CAN-Box TV-403
- 1.4. Pin-assignments

2. Installation

3. Activation of the video-in-motion function

4. Specifications

5. Technical support

1. Prior to installation

Read the manual prior to installation. Technical knowledge is necessary for installation. The place of installation must be free of moisture and away from heat sources.

1.1. Delivery contents

Take down the SW-version and HW-version of the interface boxes, and store this manual for support purposes.

CAN-box TV-403
HW_____ SW_____



Harness
TV-VW02

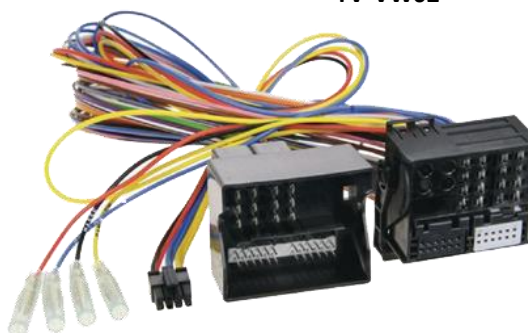

1.2. Check compatibility of vehicle and accessories

Requirements	
Vehicle	Volkswagen, Seat, Skoda and Bentley Continental GT
Navigation	MFD3/RNS510, Trinox or Columbus navigation systems

1.3. Setting the Dip-switches of the Can-Box TV-403

All vehicles Dip 1 ON, Dip 2 OFF, Dip 3 OFF

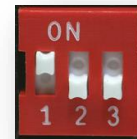

1.4. Pin-assignments

Pin-assignment vehicle connector

Cable colour	Assignment
● Red/Yellow	+12Volt Permanent Pin 15
● Brown	Ground Pin 12
● Orange/Green	CAN HIGH Pin 9
● Orange/Brown	CAN LOW Pin 10

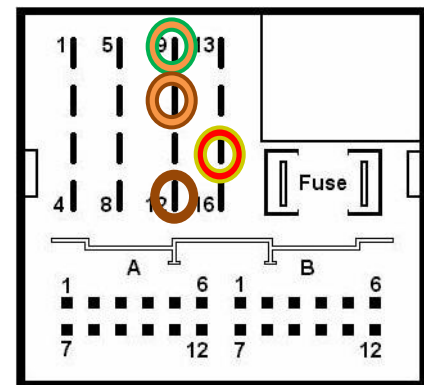

Pin-assignment of the CAN-Box TV-403 (Molex 8pin)

Cable colour	Assignment
● Red	+12Volt Permanent Pin 4
● Black	Ground Pin 8
● Yellow	CAN HIGH Navi Pin 1
● Blue	CAN LOW Navi Pin 2
● Yellow/Black	CAN High Vehicle Pin 5
● Blue/Black	CAN Low Vehicle Pin 6

2. Installation

Switch off ignition and disconnect the vehicle's battery! If according to factory rules disconnecting the battery has to be avoided, it is usually sufficient to put the vehicle in sleep-mode. In case the sleep-mode does not show success, disconnect the battery with a resistor lead.

Instruction for VW Golf 5, Touran with MFD3/RNS510:

1. Remove decorative plastic panels of the navigation computer carefully, remove the 4 TORX screws and pull the navigation computer out of the centre console with the accordant tool kit (not included).
2. Disconnect Quadlock connector from the backside of the navigation computer and connect it to harness TV-VW02. If the original Quadlock connector carries 12pin inserts, disconnect the inserts and connect them to harness TV-VW02. Connect TV-VW02 to the navigation computer.

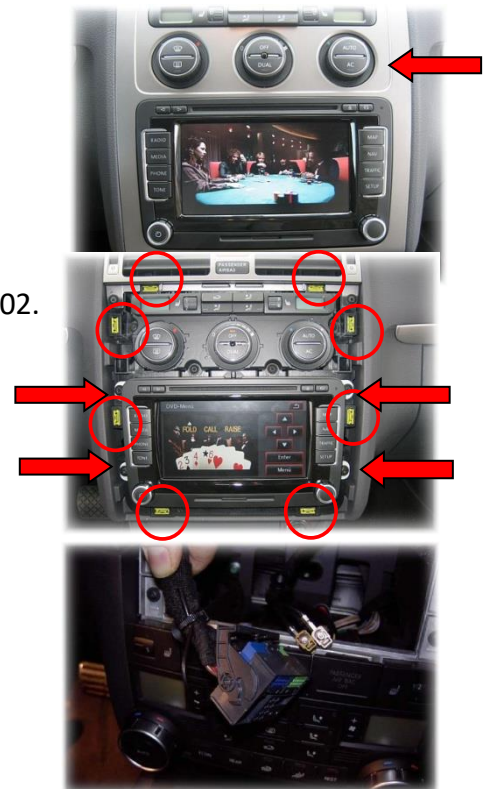

3. Activation of the video-in-motion function

The video-in-motion function is activated permanently without disturbing the navigation performance.

4. Specifications

Operation voltage	10.5 – 14.8V
Stand-by power drain	>1mA
Operation power drain	~60mA
Power consumption	~0,72W
Temperature range	-30°C to +80°C
Weight	44g
Measurements (box only) B x H x T	70 x 20 x 47 mm

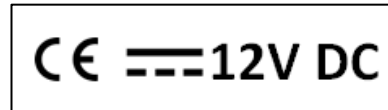

5. Technical Support

Caraudio-Systems Vertriebs GmbH
manufacturer/distribution
Rheinhorststr. 22
D-67071 Ludwigshafen am Rhein

NavLinkz GmbH
corporate sales/tech support
Eurotec-Ring 45
D-47445 Moers

phone +49 180 3 907050
email support@caraudio-systems.de

Legal disclaimer: Mentioned company and trademarks, as well as product names/codes are registered trademarks ® of their corresponding legal owners.